

GenTent Safety Canopy installations require vertical posts positioned in a rectangle configuration to support the canopy effectively. For generators with non-traditional frames, the GenTent frame post adapter kit can modify and accommodate a variety of frame variations to allow for proper support.

Depending on the model generator, installation of frame posts may be necessary on every corner.

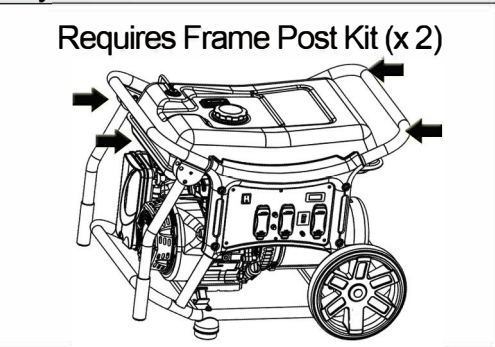

NOTE: Ridgid RD series and select other generators may have rear bumpers on the back legs which prevent the GenTent clamps from connecting directly to the frame.

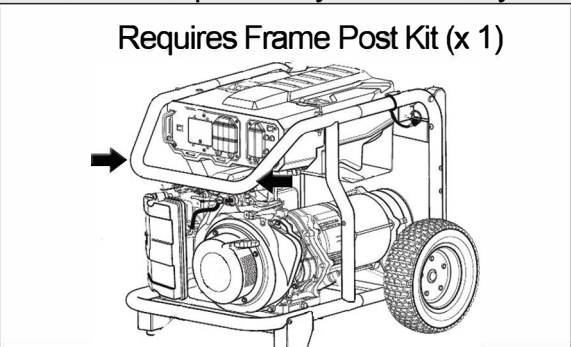
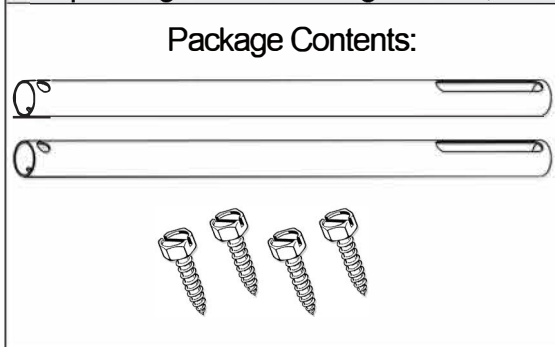
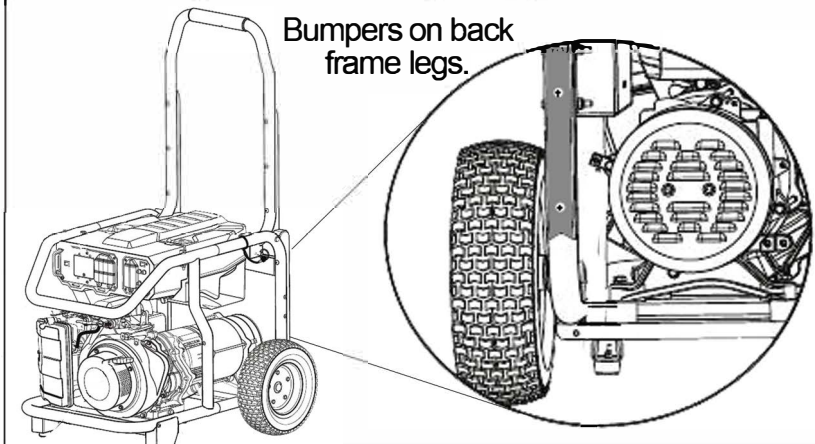

1. Measuring from existing vertical frame legs to the intended area you wish to place the frame post kit, measure along the bottom of your generator. The required distance for proper installation can range from 23"-28" along the generator length.

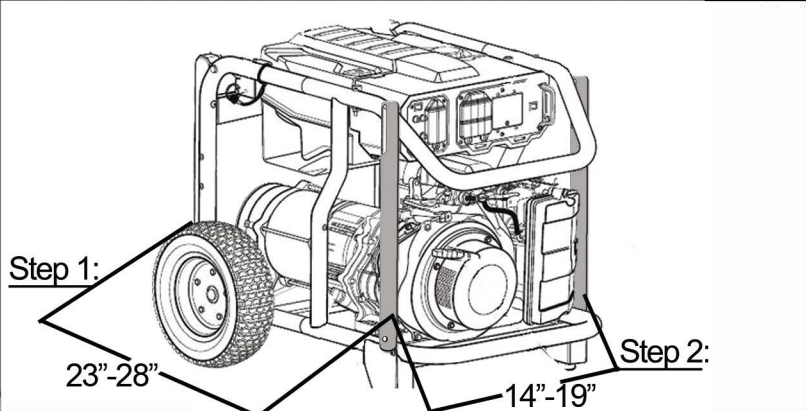

These bumpers are typically held to the frame with 3 screws each. Remove the screws, and the bumpers will separate from the frame leg easily.

2. Ensure the required width for proper installation is met. This can range depending on the placement on length, however the sum of length + width should be 42" or more.

3. Using a 5/32" metal or multi drill bit, drill pilot holes where you would like to place your frame posts. Secure the bottom of the frame post with provided screw; do not tighten all the way. Swing frame post in to vertical position.

4. Mark the center of the frame where the open slot of the frame post intersects the generator frame. Lower the frame post, and drill a pilot hole in your marked position. Secure the top of the frame post with a provide screw; tighten the lower screw.

5. Repeat this process on the opposing side of the generator; start on the bottom of the generator frame, ensuring the same length distance. Install the lower portion of the frame post first, then repeat the steps to secure the top.

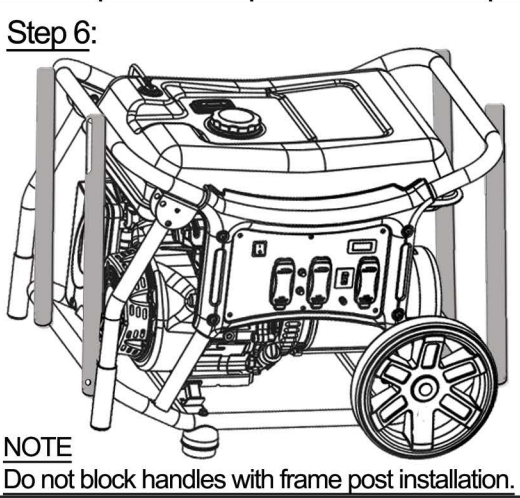
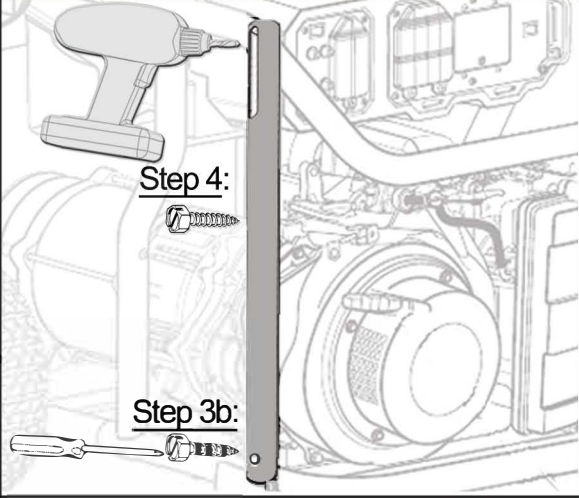
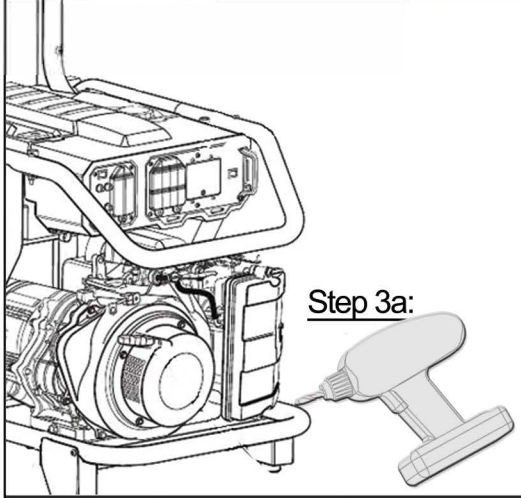

6. If your generator has NO EXISTING vertical frame legs, you will need to install frame posts on every corner.



GenTent® Accessory Bonus!

Buy any TWO (2) or more accessories receive \$10 OFF your order!

Visit GenTent.com/ReturnBonus or Call 781-334-8368



**GenTent Inverter Mounting Kit
For Fully Encased Generators**



**GenTent Universal Mounting Kit
For Open Frame Generators**



**GenTent Clear Vinyl
Electrical Apron**



**GenTent Universal
Generator Folding Handles**



**GenSkirt Outside
Storage Conversion**



**GenTent Inverter
Generator Spares Kit**



GenTent Storage Bag



**GenTent Portable
Generator Spares Kit**